

TTF 2312111

23/12/11

CATALOG NUMBER	FINISH	"L"	"S"	"D"	"P"
06J9C1O_1	ELECTRO ZINC	1 (25.4)	5/16 (7.9)	.120 (3.0)	1/4 (6.4)
06J9C1O_2	ELECTRO ZINC	1.5 (38.1)	3/8 (9.5)	.148 (3.8)	1/2 (12.7)
06J9C1O_3	ELECTRO ZINC	1.75 (44.5)	3/8 (9.5)	.148 (3.8)	1/2 (12.7)
06J9C1O_4	ELECTRO ZINC	2 (50.8)	1/2 (12.7)	.162 (4.1)	9/16 (14.3)
06J9C1O_5	ELECTRO ZINC	2 (50.8)	5/8 (15.9)	.162 (4.1)	9/16 (14.3)
06J9C1O_6	ELECTRO ZINC	2 (50.8)	5/8 (15.9)	.189 (4.8)	9/16 (14.3)
06J9C1O_7	ELECTRO ZINC	2 (50.8)	1 1/16 (27)	.189 (4.8)	5/8 (15.9)
06J9C1O_8	ELECTRO ZINC	3 (76.2)	1 1/16 (27)	.250 (6.4)	7/8 (22.2)
06J9C1O_9	ELECTRO ZINC	3 (76.2)	1 1/2 (38.1)	.250 (6.4)	7/8 (22.2)
06J9C1O_10	ELECTRO ZINC	3.5 (88.9)	1 3/4 (44.5)	.250 (6.4)	7/8 (22.2)
06J9C1O_11	HOT DP GALV	1 (25.4)	5/16 (7.9)	.120 (3.0)	1/4 (6.4)
06J9C1O_12	HOT DP GALV	1.5 (38.1)	3/8 (9.5)	.148 (3.8)	1/2 (12.7)
06J9C1O_13	HOT DP GALV	1.75 (44.5)	3/8 (9.5)	.148 (3.8)	1/2 (12.7)
06J9C1O_14	HOT DP GALV	2 (50.8)	1/2 (12.7)	.162 (4.1)	9/16 (14.3)
06J9C1O_15	HOT DP GALV	2 (50.8)	5/8 (15.9)	.162 (4.1)	9/16 (14.3)
06J9C1O_16	HOT DP GALV	2 (50.8)	5/8 (15.9)	.189 (4.8)	9/16 (14.3)
06J9C1O_17	HOT DP GALV	2 (50.8)	1 1/16 (27)	.189 (4.8)	5/8 (15.9)
06J9C1O_18	HOT DP GALV	3 (76.2)	1 1/16 (27)	.250 (6.4)	7/8 (22.2)
06J9C1O_19	HOT DP GALV	3 (76.2)	1 1/2 (38.1)	.250 (6.4)	7/8 (22.2)
06J9C1O_20	HOT DP GALV	3.5 (88.9)	1 3/4 (44.5)	.250 (6.4)	7/8 (22.2)
06J9C1O_21	COPPER COATED	1 (25.4)	1/4 (6.4)	.114 (2.9)	1/4 (6.4)
06J9C1O_22	COPPER COATED	1.25 (31.8)	1/4 (6.4)	.114 (2.9)	1/4 (6.4)
06J9C1O_23	COPPER COATED	1.5 (38.1)	5/16 (7.9)	.144 (3.7)	1/2 (12.7)
06J9C1O_24	COPPER COATED	1.75 (44.5)	3/8 (9.5)	.144 (3.7)	1/2 (12.7)
06J9C1O_25	COPPER COATED	2 (50.8)	1/2 (12.7)	.162 (4.1)	9/16 (14.3)
06J9C1O_26	COPPER COATED	2 (50.8)	5/8 (15.9)	.162 (4.1)	9/16 (14.3)
06J9C1O_27	COPPER COATED	2.25 (57.2)	25/32 (19.8)	.189 (4.8)	5/8 (15.9)
06J9C1O_28	COPPER COATED	2 (50.8)	1 1/16 (27)	.189 (4.8)	5/8 (15.9)
06J9C1O_29	COPPER COATED	2.5 (63.5)	1 1/16 (27)	.189 (4.8)	5/8 (15.9)
06J9C1O_30	COPPER COATED	3 (76.2)	1 (25.4)	.250 (6.4)	7/8 (22.2)
06J9C1O_31	COPPER COATED	3 (76.2)	1 1/16 (27)	.250 (6.4)	7/8 (22.2)
06J9C1O_32	COPPER COATED	3 (76.2)	1 1/2 (38.1)	.250 (6.4)	7/8 (22.2)
06J9C1O_33	BRIGHT WIRE	1.5 (38.1)	3/8 (9.5)	.148 (3.8)	1/2 (12.7)
06J9C1O_34	BRIGHT WIRE	2 (50.8)	1/2 (12.7)	.162 (4.1)	9/16 (14.3)
06J9C1O_35	BRIGHT WIRE	3 (76.2)	1 1/16 (27)	.250 (6.4)	7/8 (22.2)
06J9C1O_36	BRIGHT WIRE	3 (76.2)	1 1/2 (38.1)	.250 (6.4)	7/8 (22.2)
06J9C1O_37	HOT DP GALV	1.5 (38.1)	1 1/2 (38.1)	.148 (3.8)	1/4 (6.4)

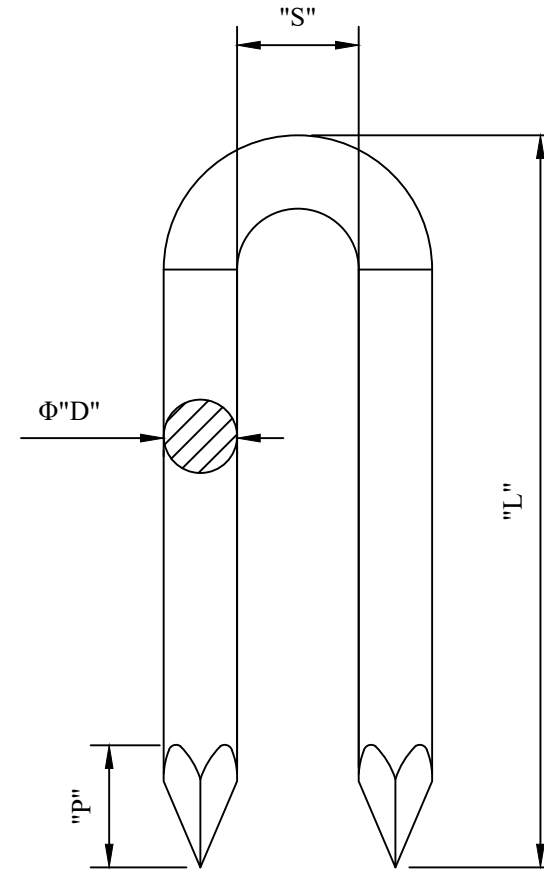

NOTES:
1.MATERIAL: STEEL WIRE.

DRN BY:	DATA
Ella	07/09/19
CONFIDENTIAL THIS DRAWING AND ITS CONTENTS PROPERTY OF TIANJIN TUOFA ELECTRIC POWER TECHNOLOGY CO.,LTD. NO PUBLICATION, DISTRIBUTION OR COPIES MAY BE MADE WITHOUT THE WRITTEN CONSENT OF TIANJIN TUOFA ELECTRIC POWER TECHNOLOGY CO.,LTD. TIANJIN TUOFA ELECTRIC POWER TECHNOLOGY CO.,LTD UNPUBLISHED ALL RIGHTS RESERVED UNDER THE COPYRIGHT LAWS.	

STAPLE



TTF POWER TECHNOLOGY CO.